

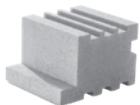

FASCIA wall collection

DESCRIPTION: Base and Structural block single-sided & double-sided **TEXTURE:** Smooth

SINGLE-SIDED

Specifications per pallet	Imperial	Metric	
 96 units / pallet	Product dimension (L x D x H)	7 7/8 x 9 1/4 x 5 7/8	200 x 235 x 150
	Cubing	96 units	96 units
		31.00 ft ²	2.88 m ²
		62.99 lin. ft	19.20 lin. m
	Approx. Weight	2 612 lbs	1 185 kg
	Number of rows	4	
	Coverage per row	7.75 ft ²	0.72 m ²
	Linear coverage per row	15.75 lin. ft	4.80 lin. m

DOUBLE-SIDED

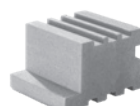
Specifications per pallet	Imperial	Metric	
 72 units / pallet	Product dimension (L x D x H)	7 7/8 x 11 1/6 x 5 7/8	200 x 281 x 150
	Cubing	72 units	72 units
		23.25 ft ²	2.16 m ²
		47.24 lin. ft	14.40 lin. m
	Approx. Weight	2 138 lbs	970 kg
	Number of rows	4	
	Coverage per row	5.81 ft ²	0.54 m ²
	Linear coverage per row	11.81 lin. ft	3.60 lin. m

BASE

Specifications per pallet	Imperial	Metric	
 66 units / pallet	Product dimension (L x D x H)	23 5/8 x 12 x 2 3/8	600 x 305 x 60
	Cubing	66 units	66 units
		25.58 ft ²	2.38 m ²
		129.92 lin. ft	39.60 lin. m
	Approx. Weight	3 701 lbs	1 679 kg
	Number of rows	11	
	Coverage per row	2.33 ft ²	0.22 m ²
	Linear coverage per row	11.81 lin. ft	3.60 lin. m

NOTES

See page 6 for icons description.

COMPATIBLE CAPS

See page 137 for product compatibility..

See page 138 to 153 for more technical information.

Pallet Overview - single-sided

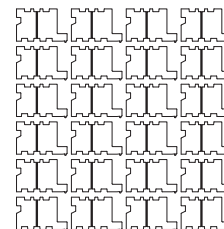

Pallet Overview - double-sided

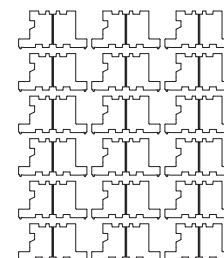

Pallet Overview - base

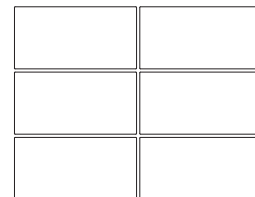

The top of Fascia Panels shall not be left exposed, they must be stabilized with a structural block on top or glued to the cap.

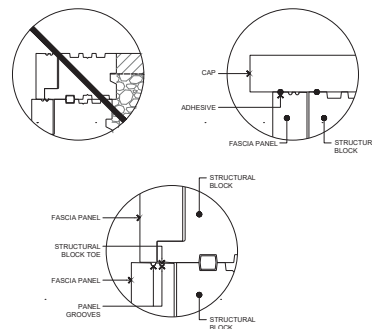



ICONIC Fascia wall collection

DESCRIPTION: Fascia Panel & Corner TEXTURE: Klean-Bloc Slate

Pallet Overview- panels

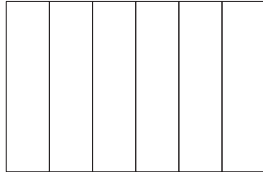

Pallet Overview- corners

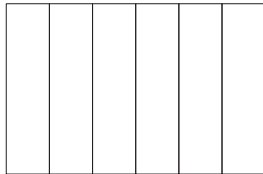

Rock Garden Brown
Victoria
Riviera
Onyx Black

FASCIA

Specifications per pallet



42 units / pallet

	Imperial	Metric
Product dimension (L x D x H)	26 x 2 3/4 x 5 7/8	660 x 70 x 150
Cubing	42 units	42 units
	44.75 ft ²	4.16 m ²
	90.94 lin. ft	27.72 lin. m
Approx. Weight	1 250 lbs	567 kg
Number of rows	7	
Coverage per row	6.39 ft ²	0.60 m ²
Linear coverage per row	13.03 lin. ft	3.96 lin. m

CORNER

Specifications per pallet



Left unit
12 units / pallet



Right unit
12 units / pallet

	Imperial	Metric
Product dimension (L x D x H) A	23 1/4 x 2 3/4 x 5 7/8	590 x 70 x 150
Product dimension (L x D x H) B	23 1/4 x 2 3/4 x 5 7/8	590 x 70 x 150
Cubing	24 units	24 units
Approx. Weight	700 lbs	318 kg
Number of rows	4	
Pillar height	35 7/16 in	900 mm

The top of Fascia Panels shall not be left exposed, they must be stabilized with a structural block on top or glued to the cap.

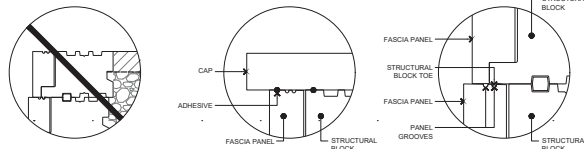

NOTES

See page 6 for icons description.

COMPATIBLE CAPS

See page 137 for product compatibility.

See page 138 to 153 for more technical information.

Fascia Panels require single-sided structural blocks (retaining wall application) or double-sided structural blocks (freestanding walls). Sold Separately.



ROSEMONT Fascia wall collection

DESCRIPTION: Fascia Panel & Corner **TEXTURE:** Klean-Bloc Slate



FASCIA

Specifications per pallet

	Imperial	Metric
 Product dimension (L x D x H)	26 x 2 3/4 x 5 7/8	660 x 70 x 150
	42 units	42 units
Cubing 42 units / pallet	44.75 ft ²	4.16 m ²
	90.94 lin. ft	27.72 lin. m
Approx. Weight	1 240 lbs	562 kg
Number of rows	7	
Coverage per row	6.39 ft ²	0.60 m ²
Linear coverage per row	13.03 lin. ft	3.96 lin. m

CORNER

Specifications per pallet

	Imperial	Metric
 Product dimension (L x D x H) A	23 1/4 x 2 3/4 x 5 7/8	590 x 70 x 150
	Product dimension (L x D x H) B	23 1/4 x 2 3/4 x 5 7/8
Cubing Left unit 12 units / pallet	24 units	24 units
	Approx. Weight	660 lbs
 Number of rows	4	
	Pillar height	35 7/16 in

Right unit
12 units / pallet

The top of Fascia Panels shall not be left exposed, they must be stabilized with a structural block on top or glued to the cap.

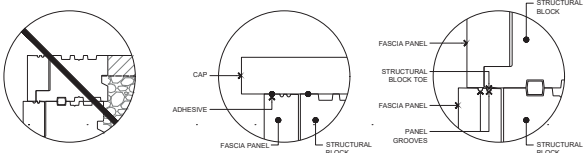

Pallet Overview - panels

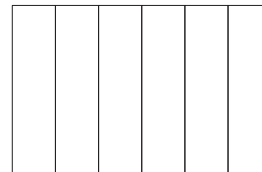

Pallet Overview - corners

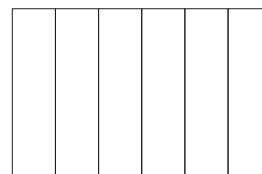

Rock Garden Brown

Klean-Bloc
Slate



Riviera

Klean-Bloc
Slate



Azzurro

Klean-Bloc
Slate



NOTES

See page 6 for icons description.

COMPATIBLE CAPS

See page 137 for product compatibility.

See page 138 to 153 for more technical information.

Fascia Panels require single-sided structural blocks (retaining wall application) or double-sided structural blocks (freestanding walls).
Sold Separately.

INSTALLATION GUIDE

FREESTANDING WALL

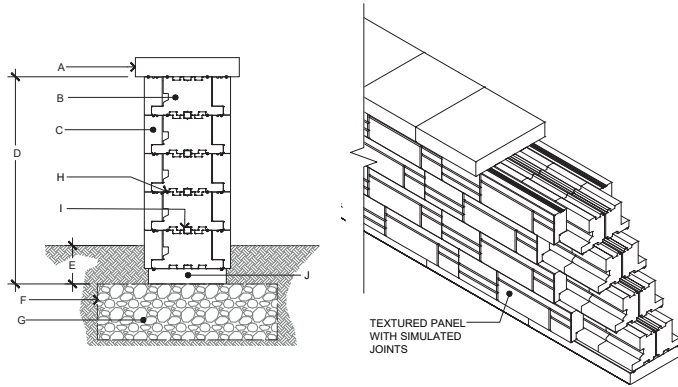

- A. TECO-BLOC CAP UNIT SECURED TO CORE AND PANEL BELOW WITH FLEXLOCK ADHESIVE
- B. STRUCTURAL BLOCK DOUBLE-SIDED UNIT
- C. PANEL UNIT
- D. 29 1/2" (750 mm) MAX.
- E. EMBEDMENT DEPTH 6" (150 mm) MIN.
- F. GEOTEXTILE
- G. COMPACTED GRANULAR BASE 6" (150 mm) MIN. THICKNESS ACCORDING TO PROJECT SPECIFICATIONS
- H. FLEXLOCK ADHESIVE
- I. HDPE HORIZONTAL KEY
- J. BASE UNIT

FREESTANDING WALL - 90° CORNER

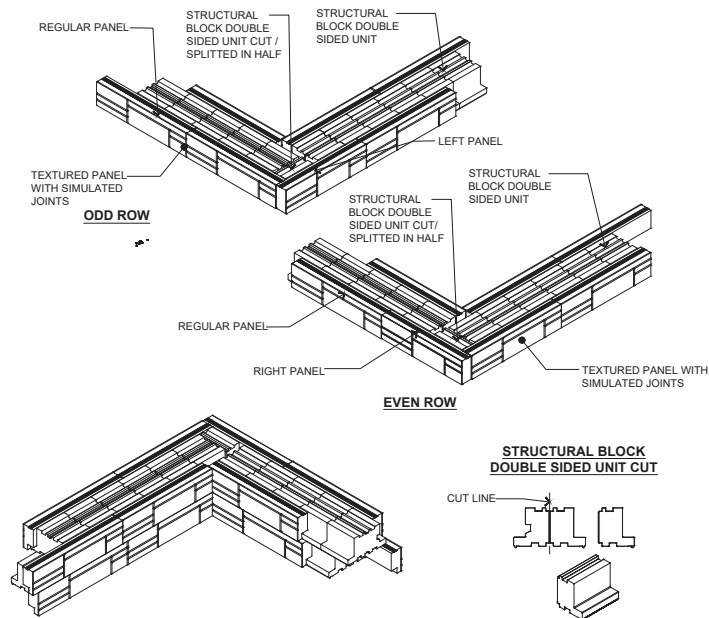

1. ALTERNATE ODD AND EVEN ROWS.
2. STAGGER STRUCTURAL BLOCKS JOINTS FROM ONE ROW TO THE NEXT.
3. GLUE ALL STRUCTURAL BLOCKS AT EACH ROW WITH FLEXLOCK ADHESIVE.
4. APPLY FLEXLOCK ADHESIVE ON TOP OF UPPERMOST PANEL UNITS TO FIX CAP UNITS.
5. STRUCTURAL BLOCK DOUBLE SIDED UNIT CUT / SPLITTED IN HALF MUST ALWAYS BE PRESENT AT THE CORNER OF THE WALL.

NOTE:

The top of Fascia Panels shall not be left exposed, they must be stabilized with a structural block on top or glued to the cap.

GRAVITY RETAINING WALL

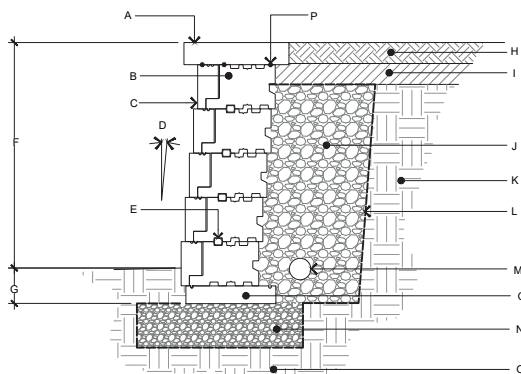

- A. TECO-BLOC CAP UNIT SECURED TO UNIT BELOW WITH FLEXLOCK ADHESIVE
- B. STRUCTURAL BLOCK SINGLE SIDED UNIT
- C. PANEL UNIT
- D. WALL INCLINATION (5.3°)
- E. HDPE HORIZONTAL KEY
- F. EXPOSED HEIGHT
- G. EMBEDMENT DEPTH
- H. TOP SOIL
- I. LOW PERMEABILITY SOIL
- J. 3/4" (20 mm) CLEAN STONE 14" (350mm) THICK MIN.
- K. RETAINED SOIL
- L. GEOTEXTILE
- M. PERFORATED DRAIN
- N. LEVELING PAD
- O. FOUNDATION SOIL
- P. FLEXLOCK ADHESIVE
- Q. BASE UNIT

INSTALLATION GUIDE

FREESTANDING END OF A STRAIGHT WALL (OPTION 1)

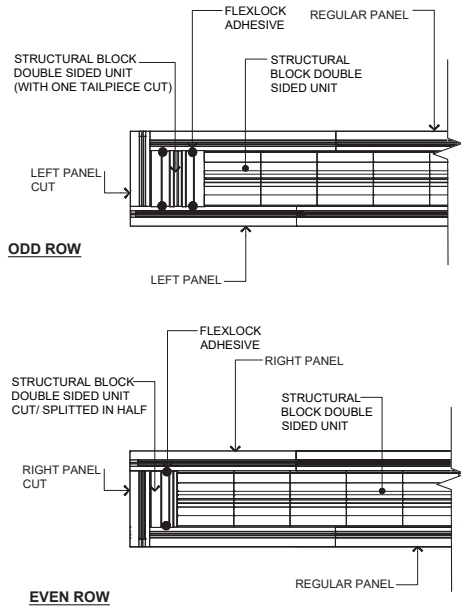

- NOTES:
1. ALTERNATE ODD AND EVEN ROWS.
 2. STAGGER STRUCTURAL BLOCKS JOINTS FROM ONE ROW TO THE NEXT.
 3. GLUE ALL STRUCTURAL BLOCKS AT EACH ROW WITH FLEXLOCK ADHESIVE.
 4. APPLY FLEXLOCK ADHESIVE ON TOP OF UPPERMOST PANEL UNITS TO FIX CAP UNITS.

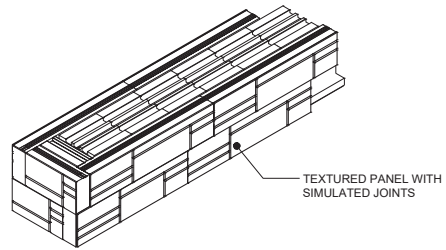

NOTE:
The top of Fascia Panels shall not be left exposed, they must be stabilized with a structural block on top or glued to the cap.

FREESTANDING END OF A STRAIGHT WALL (OPTION 2)

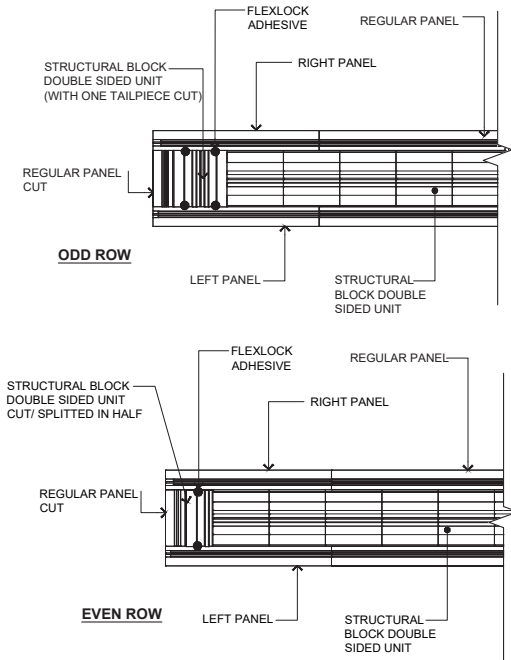

- NOTES:
1. ALTERNATE ODD AND EVEN ROWS.
 2. STAGGER STRUCTURAL BLOCKS JOINTS FROM ONE ROW TO THE NEXT.
 3. GLUE ALL STRUCTURAL BLOCKS AT EACH ROW WITH FLEXLOCK ADHESIVE.
 4. APPLY FLEXLOCK ADHESIVE ON TOP OF UPPERMOST PANEL UNITS TO FIX CAP UNITS.

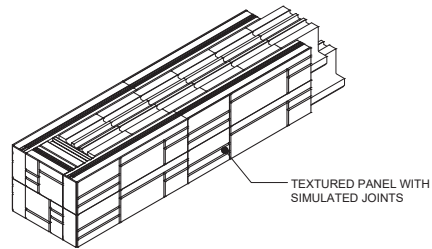

INSTALLATION GUIDE

PILLARS - FASCIA WALL COLLECTION

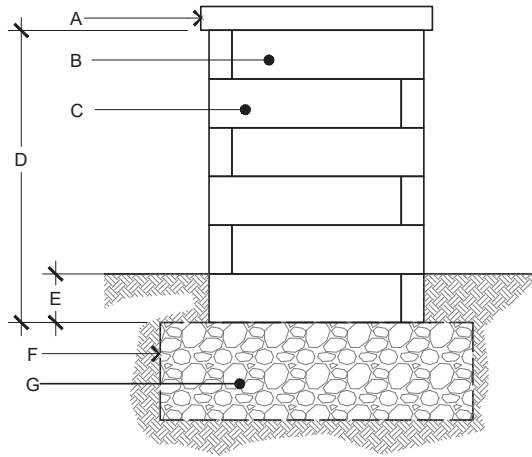

STRUCTURAL BLOCK SINGLE SIDED UNIT CUT / SPLITTED IN HALF

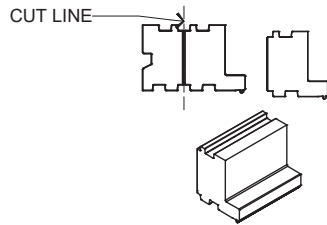

- A. PILLAR CAP UNIT SECURED TO CORE AND PANEL BELOW WITH FLEXLOCK ADHESIVE
- B. RIGHT PANEL
- C. LEFT PANEL
- D. 35 7/8" (900 mm) MAX HEIGHT
- E. EMBEDMENT DEPTH 6" (150 mm) MIN.
- F. GEOTEXTILE
- G. COMPACTED GRANULAR BASE 6" (150 mm) MIN. THICKNESS ACCORDING TO PROJECT SPECIFICATIONS.

NOTE:

The top of Fascia Panels shall not be left exposed, they must be stabilized with a structural block on top or glued to the cap

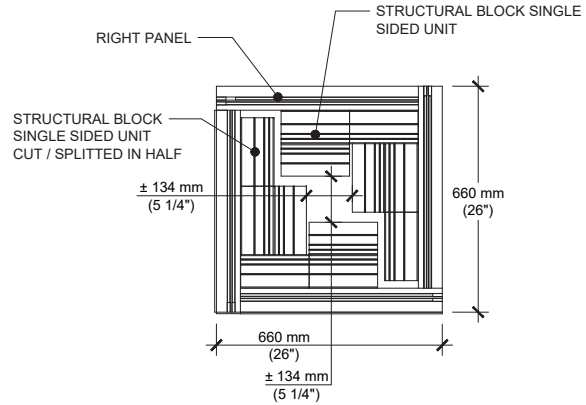

ODD ROW

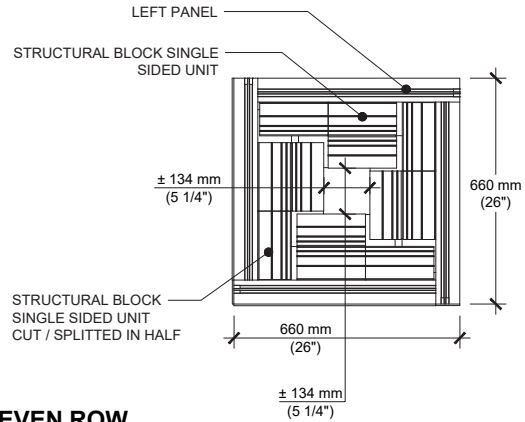

EVEN ROW

IIN.

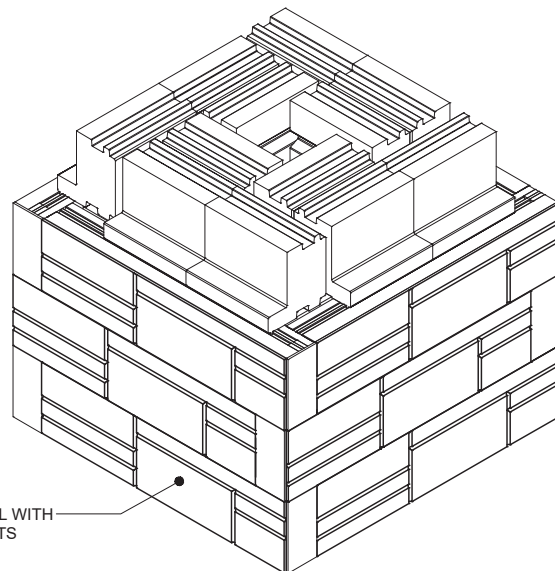

TEXTURED PANEL WITH SIMULATED JOINTS

For all possible combinations of pillars and caps, please refer to the correspondence table on page 137

INSTALLATION GUIDE

STEPS - FASCIA WALL COLLECTION

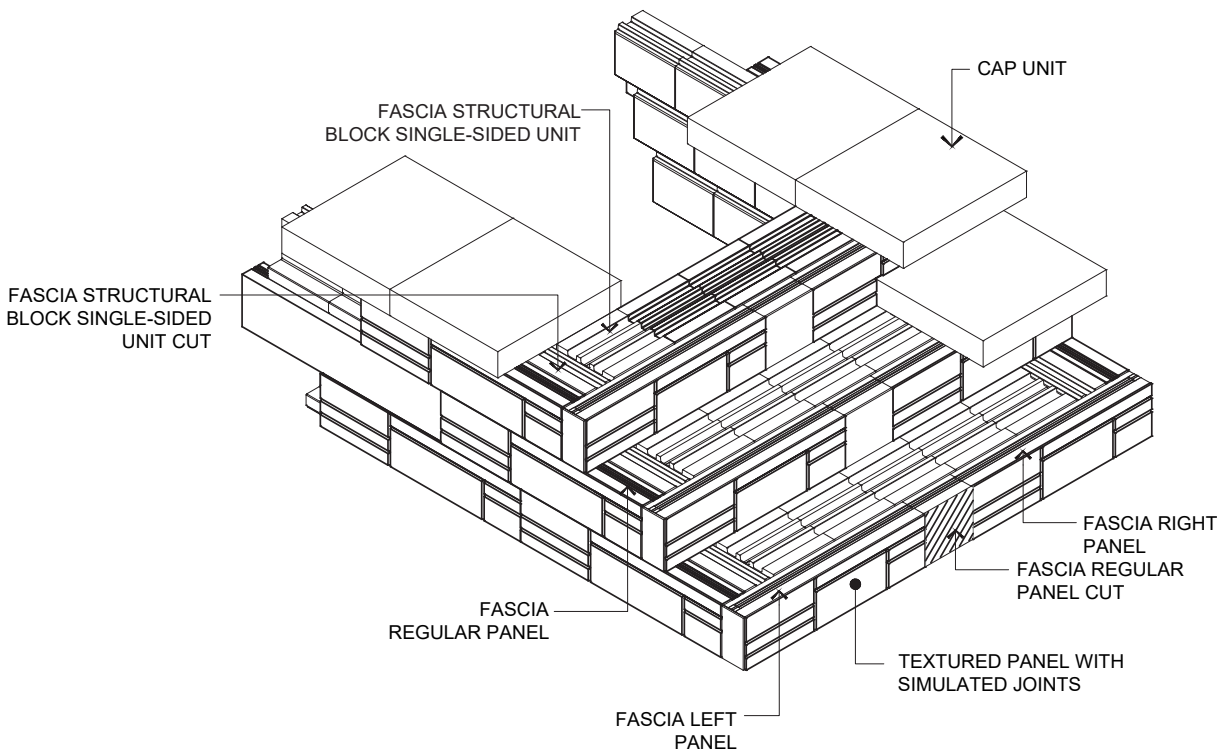
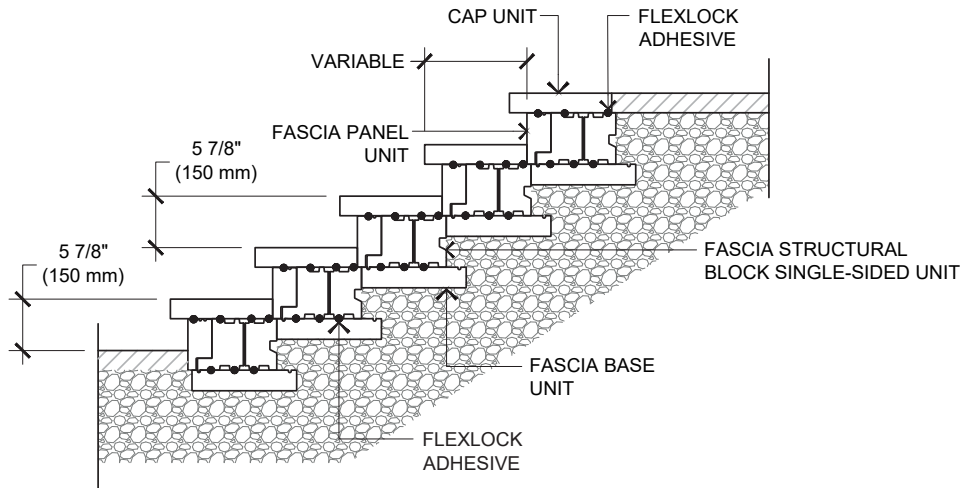

NOTE:

The top of Fascia Panels shall not be left exposed, they must be stabilized with a structural block on top or glued to the cap

Check with your local Building Codes to determine any restrictions or guidelines regarding the dimensions of steps (including riser height and step tread) as well as handrail specifications.